

Body Electrical System

AUDIO SYSTEM

AUDIO REMOTE CONTROL	
CIRCUIT DIAGRAM	BE -2
INSPECTION	BE -3
REPLACEMENT	BE -3

POWER DOOR MIRRORS

POWER DOOR MIRROR SWITCH	
INSPECTION	BE -4

LIGHTING SYSTEM

SPECIFICATION	BE -5
HEAD LAMP	
REMOVAL	BE -5
REPLACEMENT	BE -6
ADJUSTMENT	BE -7
TURN/HAZARD LAMPS	
INSPECTION	BE -10
FRONT FOG LAMPS	
INSPECTION	BE -10
REPLACEMENT	BE -11

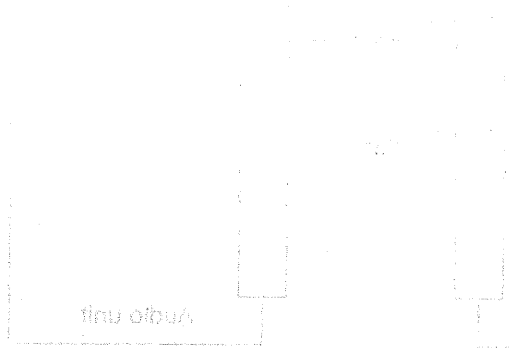

AUDIO SYSTEM

AUDIO REMOTE CONTROL

CIRCUIT DIAGRAM EACD039E

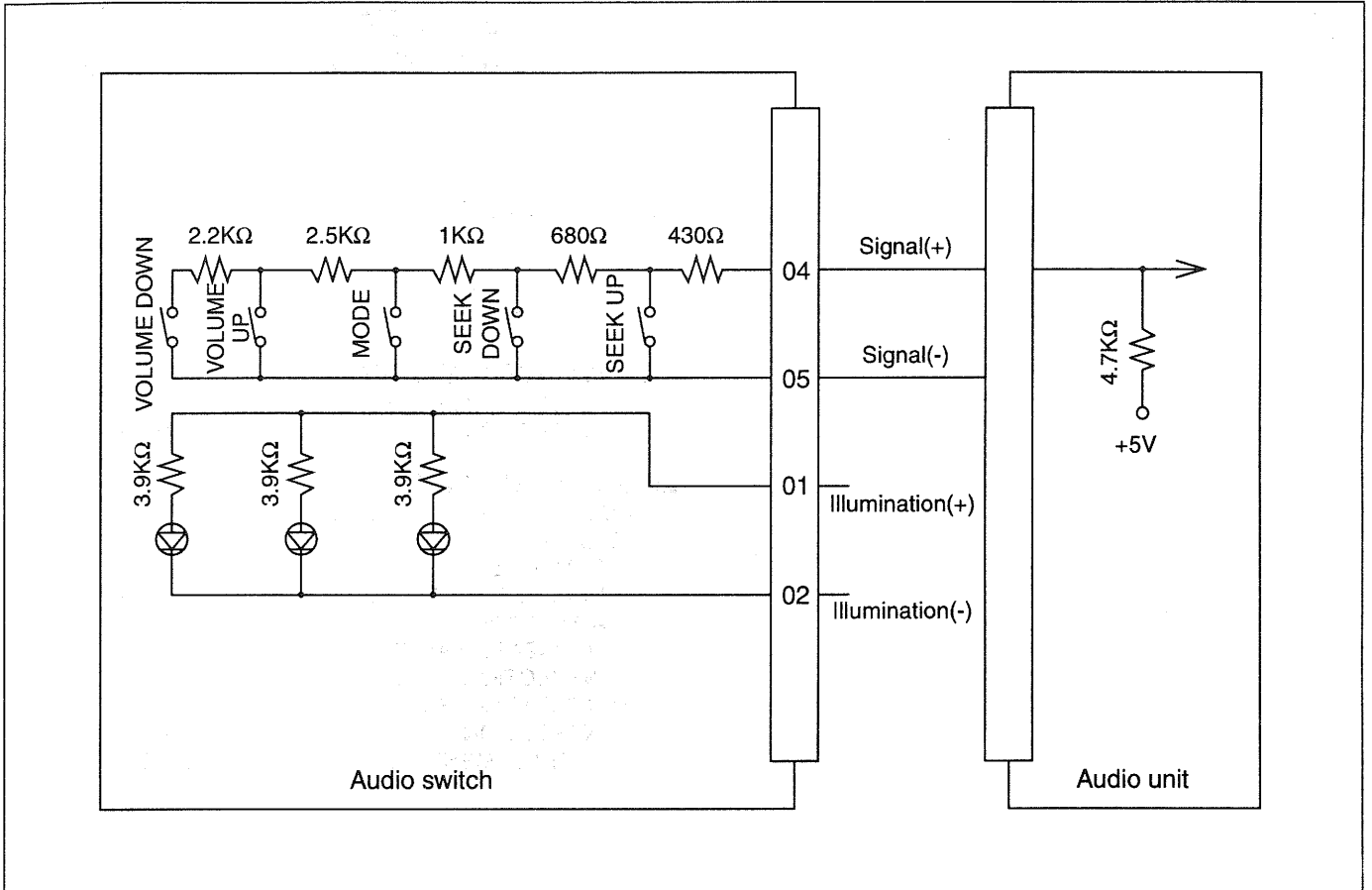

INSPECTION E54B7CAF

1. Check for resistance between No.4 and No.5 terminals in each switch position.

Switch	Connector terminal	Resistance (±5%)
VOLUME DOWN	4 - 5	6.81 kΩ
VOLUME UP	4 - 5	4.61 kΩ
SEEK UP	4 - 5	430 Ω
SEEK DOWN	4 - 5	1.11 kΩ
MODE	4 - 5	2.11kΩ

3. Remove the steering wheel lower cover (B) after loosening the screw.

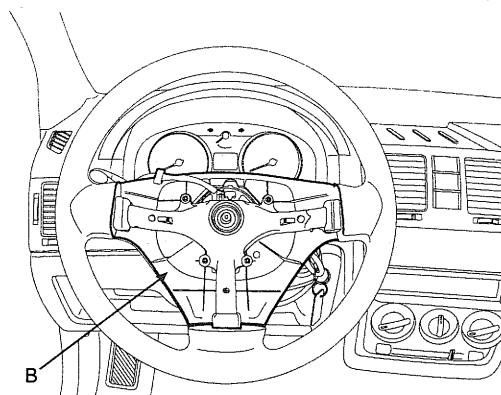

KTPF452A

4. Remove the audio remote control switch connector after remove the steering wheel remote control switch and 2 screws.

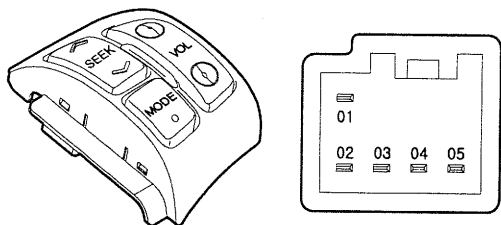

KTPF024A

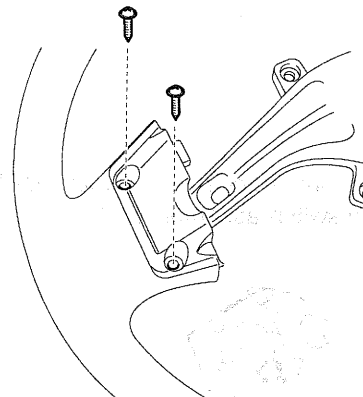

KTPF024B

REPLACEMENT E4B500C8

1. Disconnect the negative (-) battery terminal.
2. Remove the driver airbag module. & steering wheel (A). (Refer to the airbag group)

5. Installation is the reverse of removal.

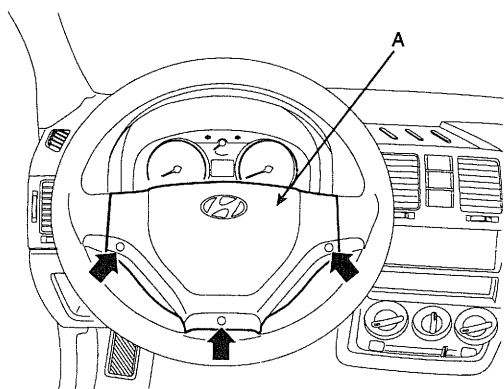

KTPF452B

POWER DOOR MIRRORS

POWER DOOR MIRROR SWITCH

INSPECTION ED5F1A85

1. Disconnect the negative (-) battery terminal.
2. Remove the power window switch assembly (A) by using scraper after loosening a screw.

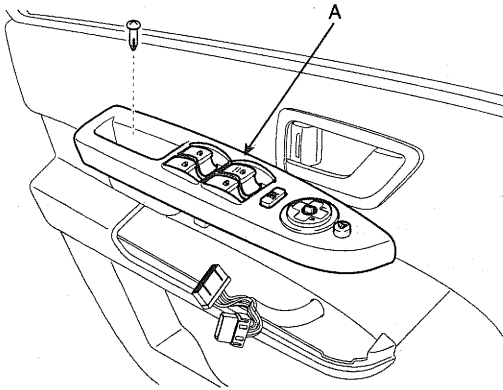

KTPF301A

3. Remove the power door mirror switch (B) from the power window switch assembly (A).

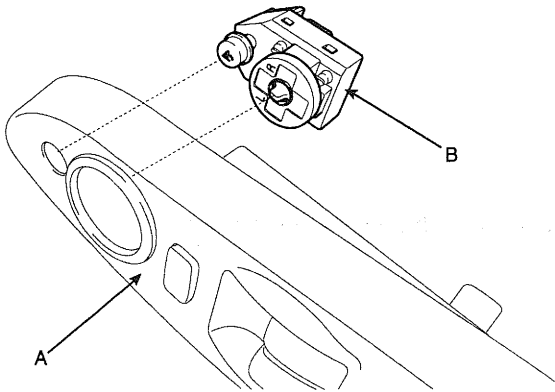

KTPF301B

4. Check the power door mirror operation after replacing new power door mirror switch.

LIGHTING SYSTEM

SPECIFICATIONS

E1CA4EFB

Items	Bulb Wattage (W)
Head lamp(HIGH/LOW)	60/55
Room lamp	10
Map lamp	10
Front turn signal lamp	21
Front fog lamp	27
High mounted stop lamp	16
Side repeater	5
Stop/ Tail lamp	21/5
Rear turn signal lamp	21
Back - up lamp	16
Rear fog lamp	21
License plate lamp	5

HEAD LAMPS

REMOVAL

EFCF011F

1. Disconnect the negative (-) battery terminal.
2. Remove the 6 bolts holding the front bumper upper cover.

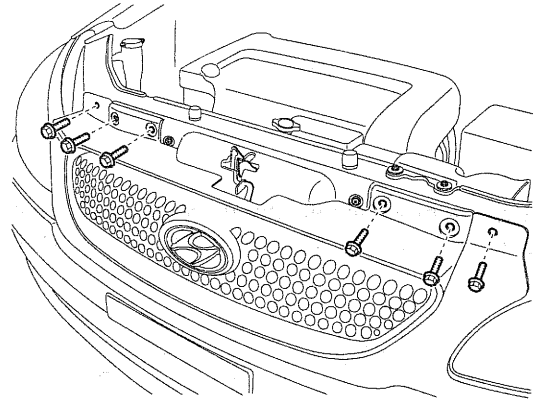

KTPF491A

3. Remove the head lamp mounting 2 bolts by using wrench (A).

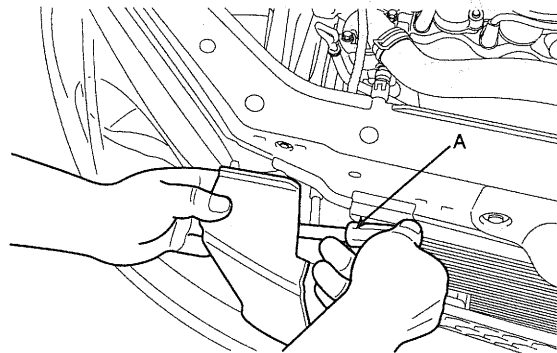

KTPC445B

REPLACEMENT E6ABFF2A

1. Remove the turn signal lamp bulb (A) after turning it counterclockwise.
2. Remove the head lamp bulb after removing the connector (B) and the clip (C) & a screw.

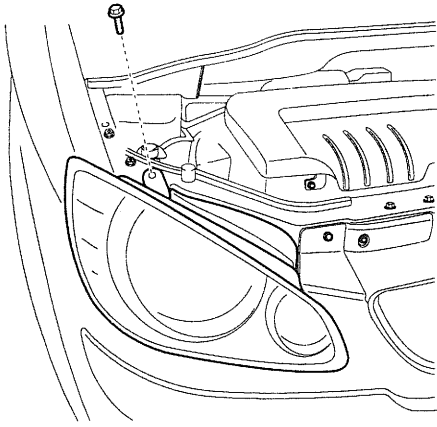

KTPF491B

4. Remove the head lamps after disconnecting the turn signal lamp connector (B) and head lamp connector (A).

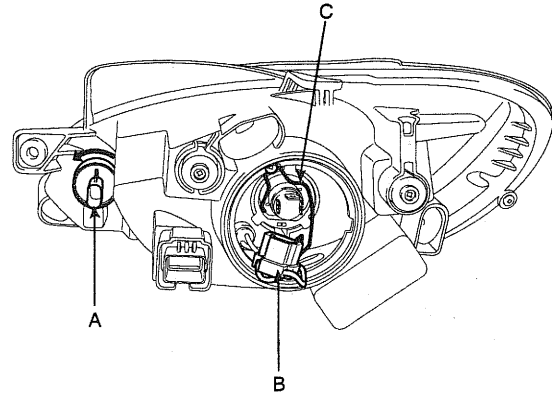

KTPF491D

3. Replace the turn signal lamp bulb (A) and the head lamp bulb (B).

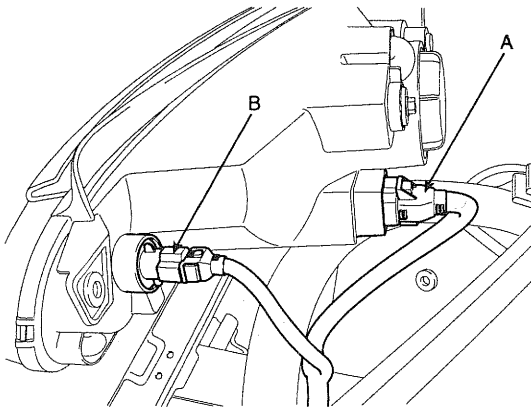

KTPF491C

5. Installation is the reverse of removal.

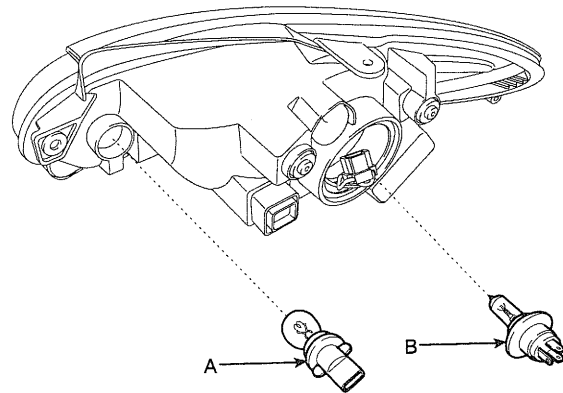

KTPF491E

ADJUSTMENT EDE80E3E

HEAD LAMP AIMING INSTRUCTIONS

The head lamps should be aimed with the proper beam-setting equipment, and in accordance with the equipment manufacturer's instructions.

NOTE

If there are any regulations pertinent to the aiming of head lamps in the area where the vehicle is to be used, adjust so as to meet those requirements.

Alternately turn the adjusting gear to adjust the head lamp aiming. If beam-setting equipment is not available, proceed as follows :

1. Inflate the tires to the specified pressure and remove any loads from the vehicle except the driver, spare tire, and tools.
2. The vehicle should be placed on a flat floor.
3. Draw vertical lines (Vertical lines passing through respective head lamp centers) and a horizontal line (Horizontal line passing through center of head lamps) on the screen.
4. With the head lamp and battery in normal condition, aim the head lamps so the brightest portion falls on the horizontal and vertical lines. Make vertical and horizontal adjustments to the lower beam using the adjusting wheel.

FRONT FOG LAMP AIMING

The front fog lamps should be aimed in the same manner of the head lamps aiming. With the front fog lamps and battery normal condition, aim the front fog lamps by turning the adjusting gear (A).

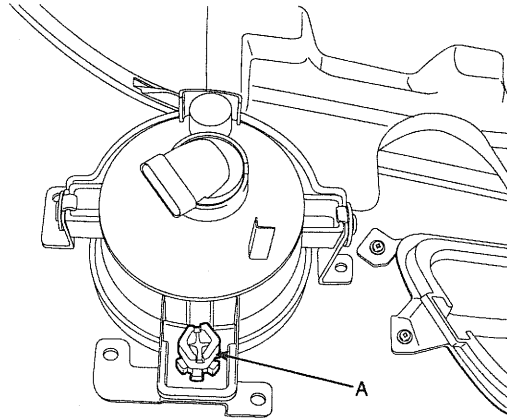

KTPF491G

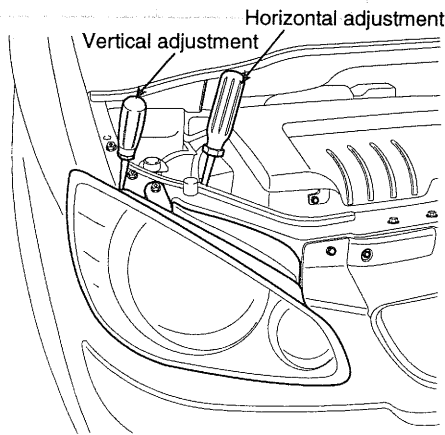

ETPF491F

HEAD LAMP AND FOG LAMP AIMING POINT

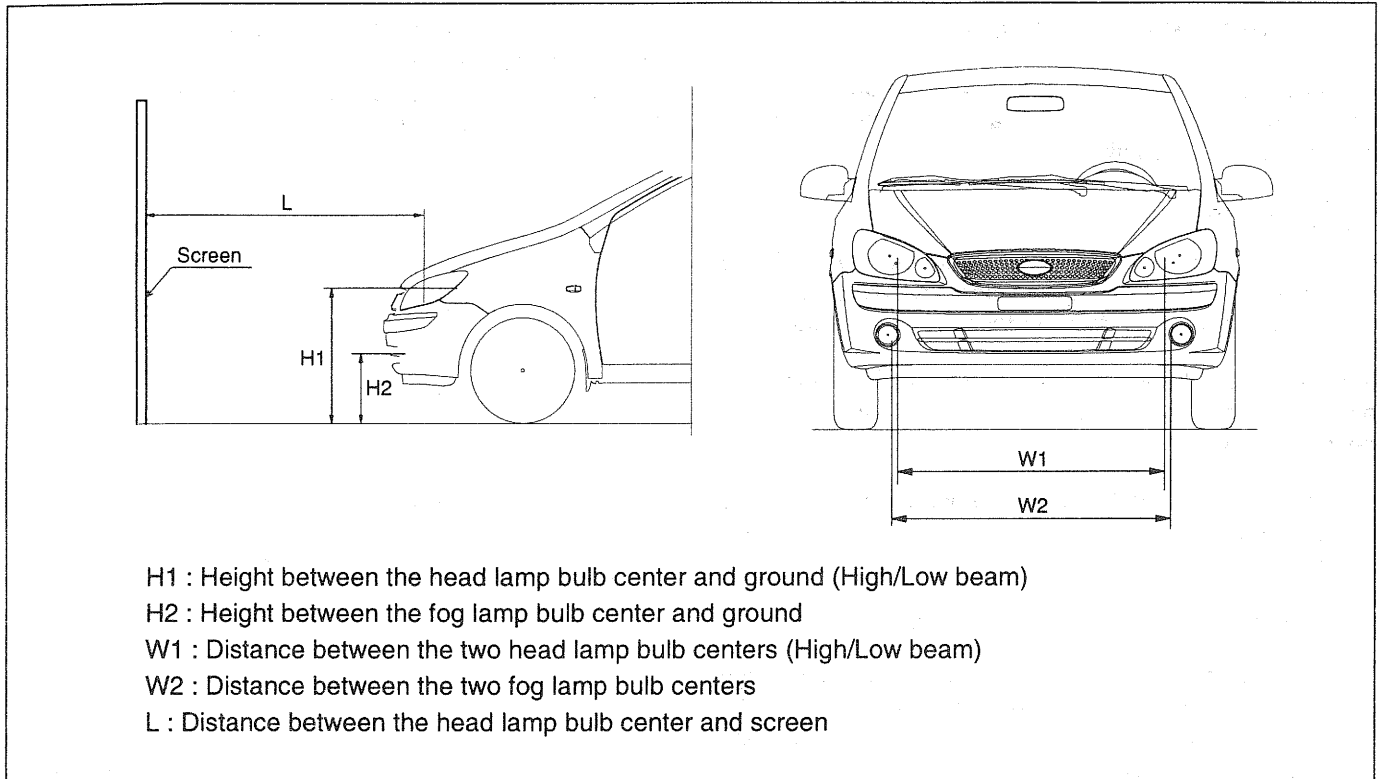

ETPF491H

Unit : in.(mm)

Vehicle condition	H1	H2	W1	W2	L
Without drivers	27.2(691)	14.2(363)	46.2(1,176)	46.7(1,188)	118(3,000)
With a driver	27(686)	14(358)			

ETPF505C

1. Turn the low beam on without drivers aboard. The cut-off line should be projected in the allowable range (shaded region). If head lamp leveling device is equipped, adjust the head lamp leveling device switch with 0 positions.

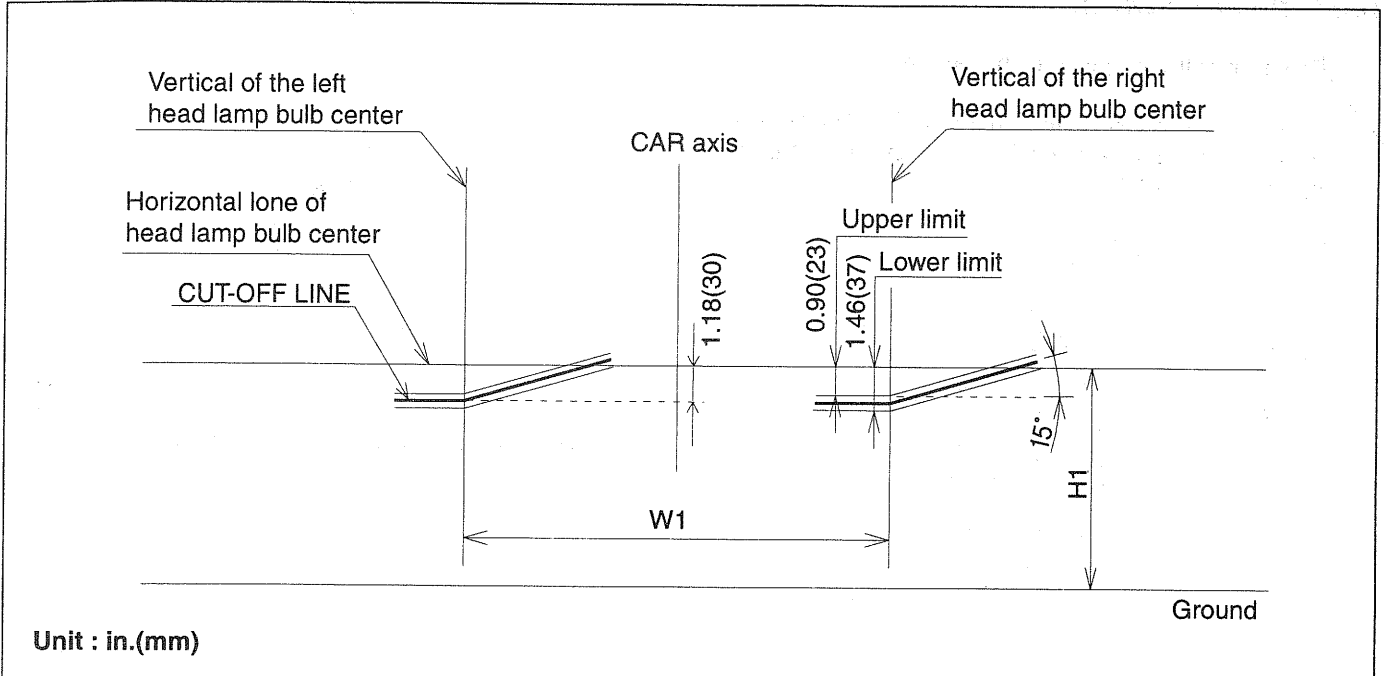

LTJF491H

2. Turn the front fog lamp on without the driver aboard. The cut-off line should be projected in the allowable range (shaded region).

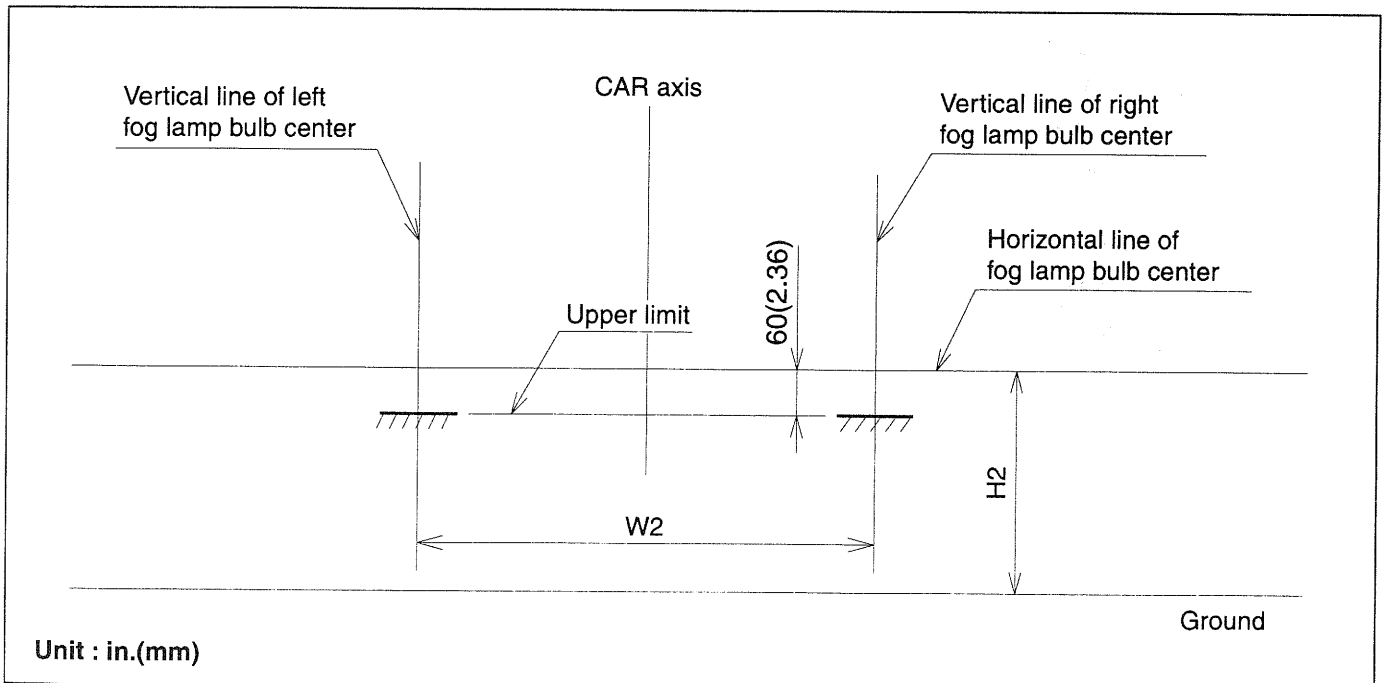

LTJF491J

TURN / HAZARD LAMPS

INSPECTION E4AD5A96

HAZARD LAMP SWITCH

1. Disconnect the negative (-) battery terminal.
2. Remove the center facia panel (A) after pulling it by using regular screw driver (-). Take care not to damage fixing clips (C).

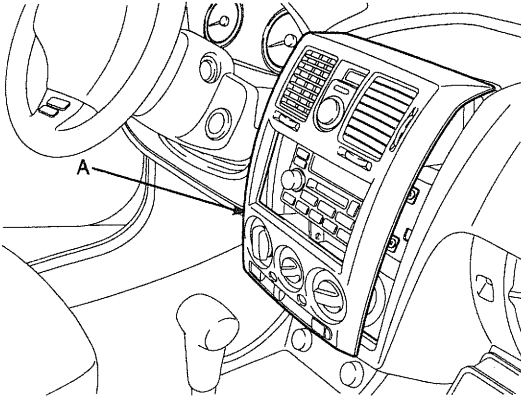

KTPF495A

3. Remove the hazard lamp switch assembly (B) from the center facia panel after disconnecting the connectors.

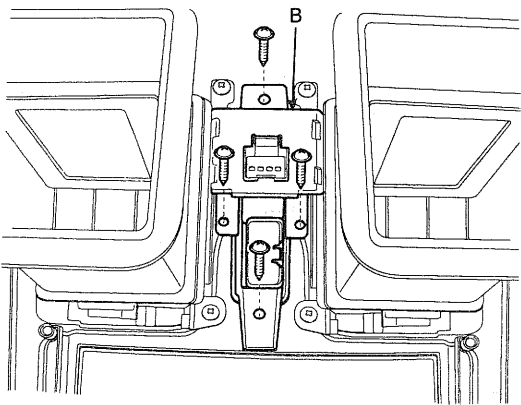

KTPF495B

4. Remove the hazard lamp switch (B) from the digital clock & hazard lamp switch assembly (A).

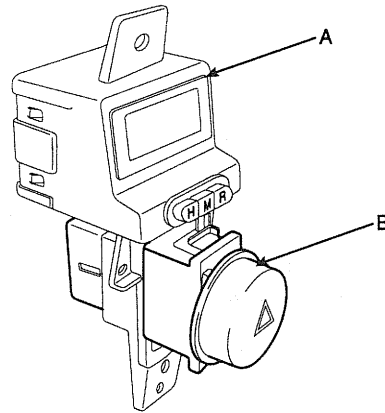

KTPF495C

5. Replace new hazard lamp switch and Check the operation.

FRONT FOG LAMPS

INSPECTION E8EE8B72

RELAY INSPECTION

1. Check the relays are fixed strongly in each module.
2. Check if the relays are proper type.

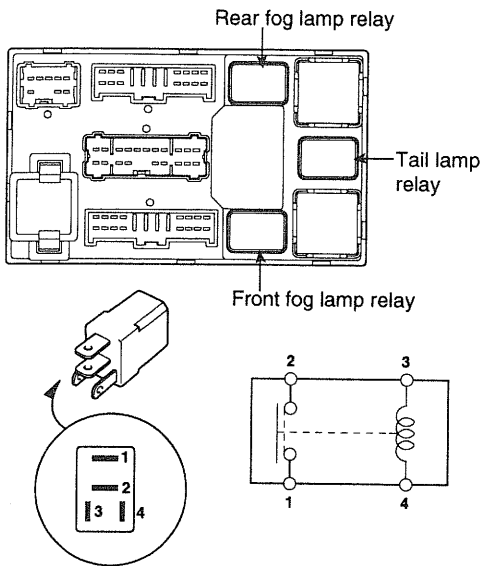

ETPD224B

REPLACEMENT E5FCFBDA

FRONT FOG LAMP

1. Disconnect the negative (-) battery terminal.
2. Remove the front bumper. (Refer to the Body group - front bumper)
3. Disconnect the front fog lamp connector (A).

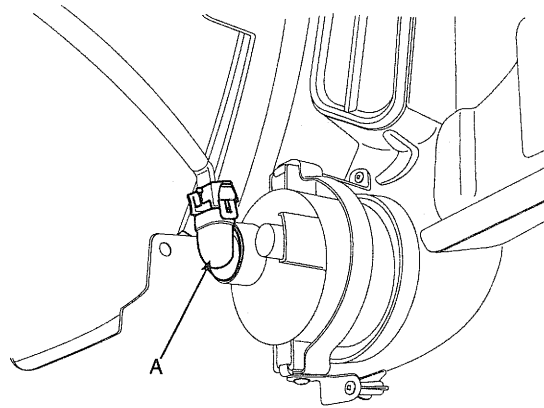

KTPF496B

4. Remove the front fog lamp (B) from the front bumper after loosening 4 screws.

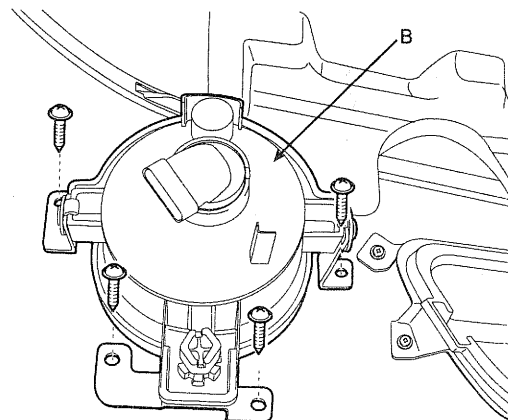

KTPF496C

5. Installation is the reverse of removal.

FRONT FOG LAMP SWITCH INSPECTION

1. Disconnect the negative (-) battery terminal.
2. Remove the front fog lamp switch (A) by pulling it at the behind side of the crash pad lower pad.

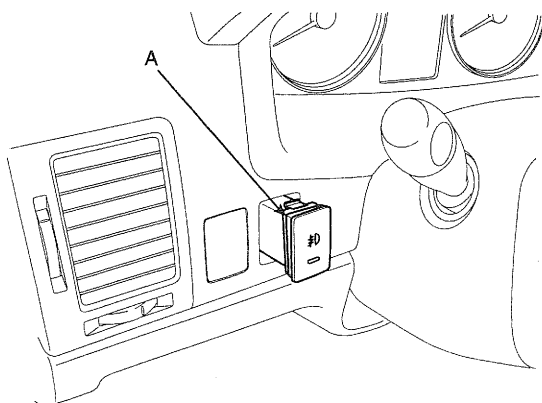

KTPF496A

3. Replace new front fog lamp switch and Check the operation.

FRONT FOG LAMP BULB

1. Disconnect the negative (-) battery terminal.
2. Remove the front bumper. (Refer to the Body group - front bumper)
3. Disconnect the front fog lamp connector (A).

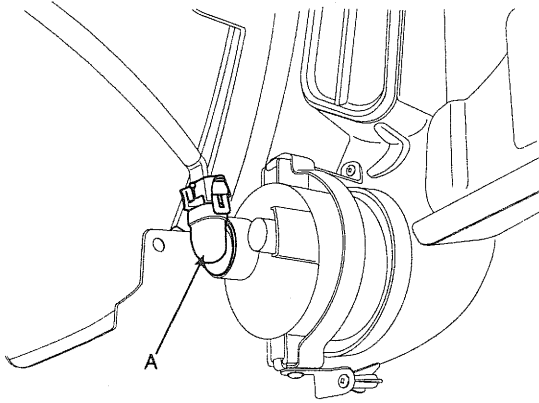

KTPF496B

4. Remove the bulb (C) from the front fog lamp assembly (B) after turning it counterclockwise.

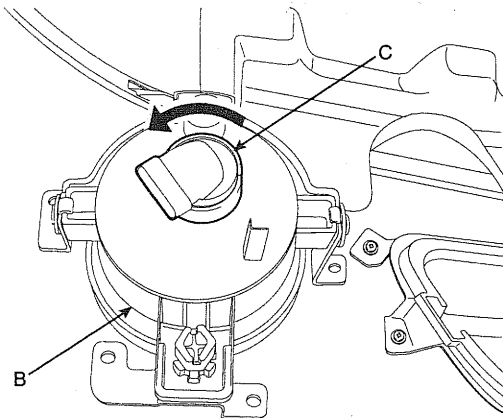

KTPF496D

5. Replace new bulb (C).

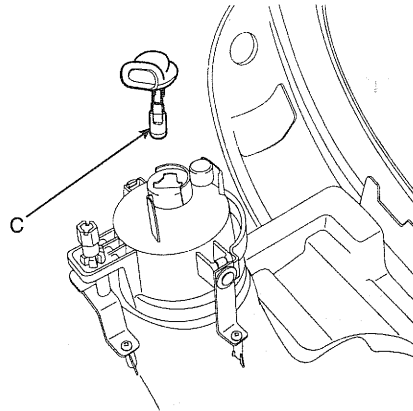

KTPF496E